

■ **FEATURES**

These coils enable noise suppression but without influence on signals. These products employ high performance ferrite with superior frequency characteristics, compact size, high performance, and low cost.

These EMC coils are also available in tape format for automatic insertion equipment.

■ **APPLICATION**

These EMC coils are used for EMI countermeasures at signal lines of personal computer and peripheral devices.

■ **DIMENSIONS (Unit :mm)**

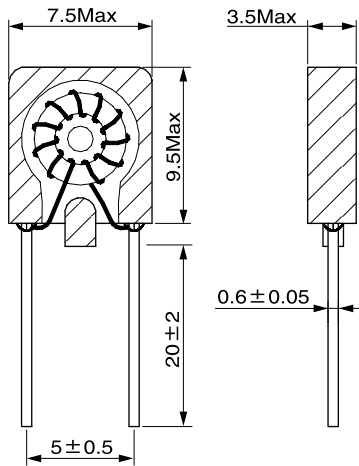

■ **PRODUCT SPECIFICATIONS**

Part Number	Impedance ( $\mu$ H) at 1 KHz	Impedance( $\Omega$ )Min.		Rated DC Current (mA)	DC Resistance ( $\Omega$ m) Max.
		Frequency (MHz)	Z		
MEMC421-080	8 $\pm$ 50%	300	150	500	20
MEMC421-100	10 $\pm$ 50%	200	170	500	20
MEMC421-400	40 $\pm$ 35%	60	550	500	34
MEMC421-600	60 $\pm$ 35%	40	900	500	50
MEMC421-800	80 $\pm$ 35%	30	1200	500	60
MEMC421-121	120 $\pm$ 35%	30	1600	250	95
MEMC421-151	150 $\pm$ 35%	20	2200	250	110

■ **GENERAL SPECIFICATIONS**

1. Operating temperature range .....-25°C to +70°C
2. Rated voltage .....50V
3. Withstand voltage .....DC 200V (Between line to cover)
4. Insulation resistance .....DC 110V / 10M  $\Omega$  Min. (Between line to cover)

LEADED TYPE

■ TYPICAL ELECTRICAL CHARACTERISTIC CURVES

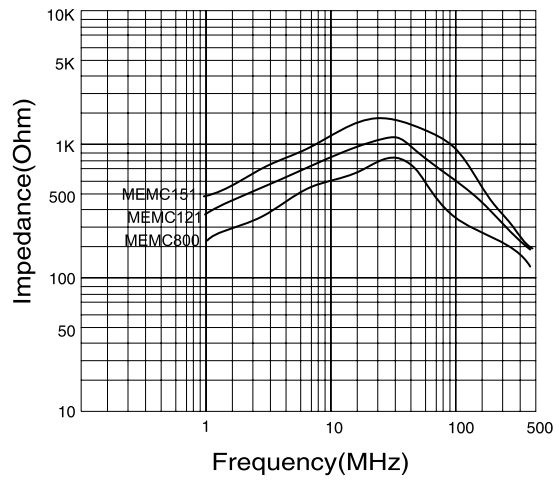
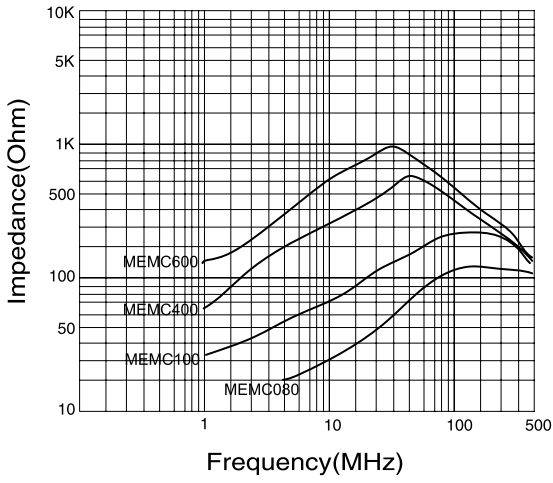

**FEATURES**

These product employ high performance ferrite with superior frequency characteristics, compact size, high performance , and low cost. Common mode line filters enable common-mode noise suppression without influence on signals. These filters are also available in tape format for automatic insertion equipment.

**APPLICATION**

These common mode line filters are used for EMI countermeasures at signal lines of personal computer and peripheral devices.

**DIMENSIONS (Unit :mm)**

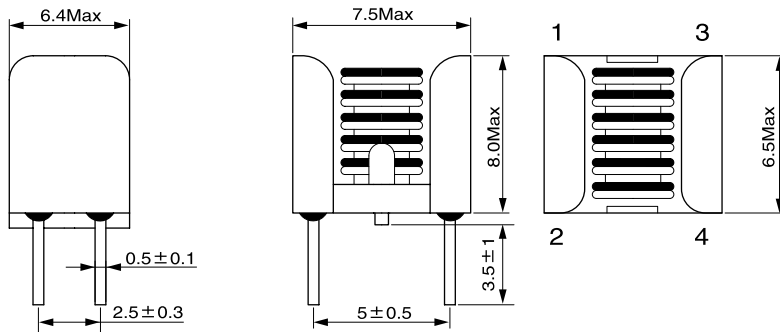

**Schematic**

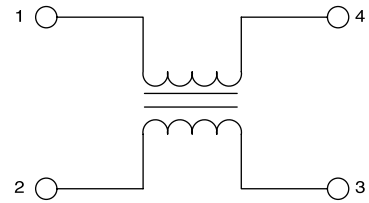

**PRODUCT SPECIFICATIONS**

Part Number	Inductance L @ 1KHz ( μ H)	Impedance(Ω )Min.		Rated DC Current (mA)	DC Resistance (Ω m) Max.
		Frequency (MHz)	Z		
MEMC-648075-160	16 ± 50%	100	380	500	35
MEMC-648075-400	40 ± 50%	50	900	500	45
MEMC-648075-600	60 ± 35%	40	1250	500	50
MEMC-648075-800	80 ± 35%	30	1300	500	60

**GENERAL SPECIFICATIONS**

1. Operating temperature range .....-25°C to +70°C
2. Rated voltage .....50V
3. Withstand voltage .....DC 200V (Between line to cover)
4. Insulation resistance .....DC 110V / 10MΩ Min. (Between line to cover)

**TYPICAL ELECTRICAL CHARACTERISTIC CURVES**

